

AUDLEY SMALL & MEDIUM LANTERNS

GLO1201; GLO1201C; GLO1211; GLO1211C

General Product Information

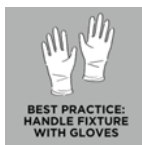
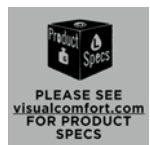
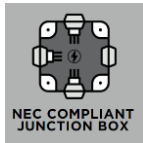
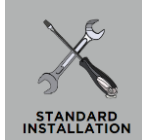
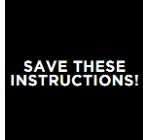

Tools Required



Safety Information

CAUTION-RISK OF FIRE

This product must be installed in accordance with the applicable installation code by a person familiar with the construction and operation of the product and the hazards involved.

USE MINIMUM 90°C SUPPLY CONDUCTORS.



Turn off electrical current at the source before working with any lighting fixture or portable lamp.

Install and use this product in adherence with local electrical codes and regulations.

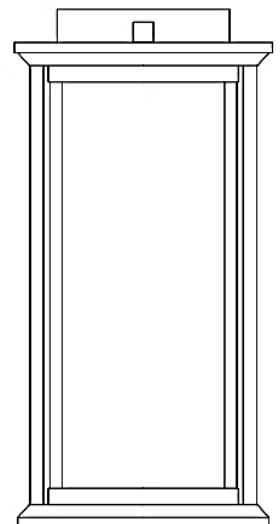
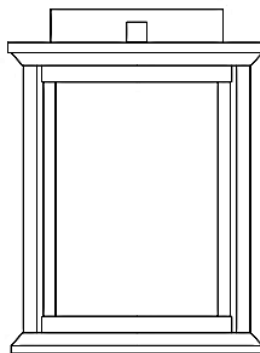

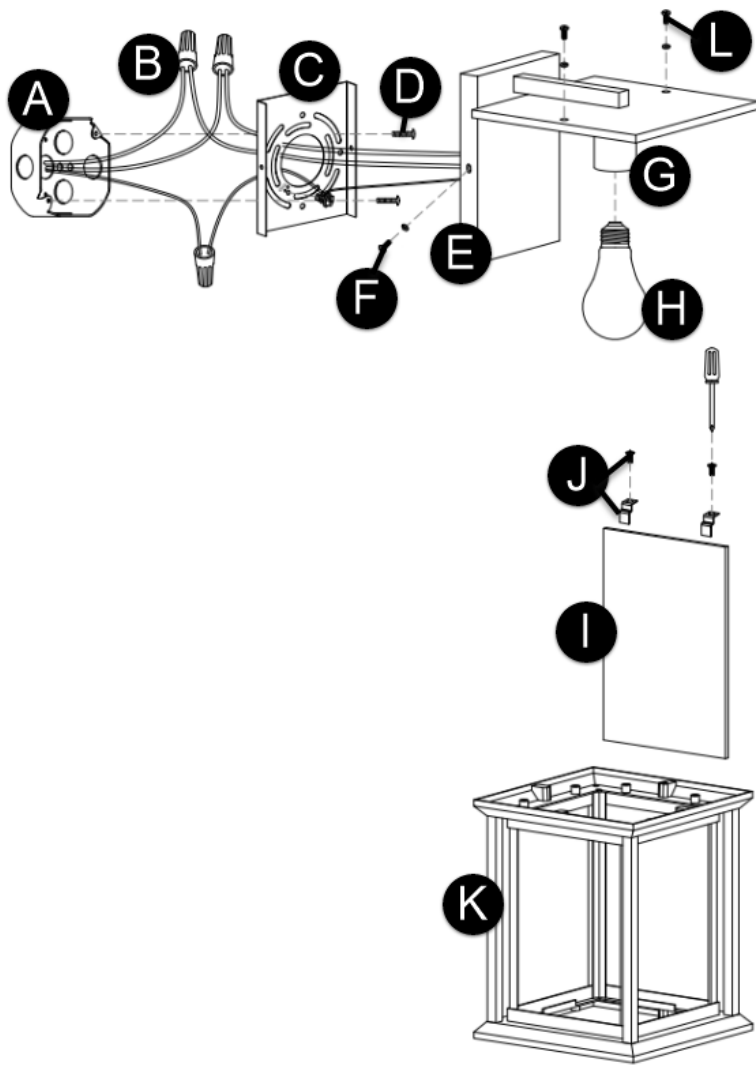

FIXTURE PARTS

- A. Junction Box
- B. Wire Nut Connections
- C. Mounting Plate
- D. Mounting Screws
- E. Fixture Base
- F. Fixture Screws & Washers
- G. Socket
- H. Bulb (Not Included)
- I. Glass Panels
- J. Clips and Clip Screws
- K. Fixture Frame
- L. Frame Screws

INSTRUCTIONS

I. Preparing the Fixture

1. Remove the mounting plate from the fixture base.
2. Install the mounting plate to the junction box and secure it using the mounting screws.

II. Wiring the Fixture

1. Safety first! Locate the circuit breaker and switch it off to cut off the power supply to the relevant circuits to ensure there's no electricity running through the wiring.
2. In accordance with local electrical codes, connect the fixture ground wire (bare copper or silver wire) to suitable ground. This may be a green ground screw on the mounting plate, which the ground wire should be tightly wrapped around or a house wire (green or bare copper wire without insulation).
3. Twist the bare ends of the following pairs of wires together using a wire nut to secure a connection:
 - a) Hot fixture wire (black) to hot power line wire from the junction box (hot to hot)
 - b) Neutral fixture wire (white) to neutral power line wire from the junction box (neutral to neutral)
4. Carefully tuck all the wires into the junction box.

III. Installing the Fixture

1. Mount the fixture base onto the mounting plate and secure it in place by installing the fixture screws.
2. Screw the bulbs into the sockets. Refer to the socket labels for max wattage information.
3. Secure the glass panels to the fixture frame with the clips and clip screws.
4. Use the frame screws to secure the fixture frame to the fixture base.
5. For wet locations, caulk around the base of the fixture with waterproof construction sealant.